

**"Wow House"**

# 3268G

## FLEX I

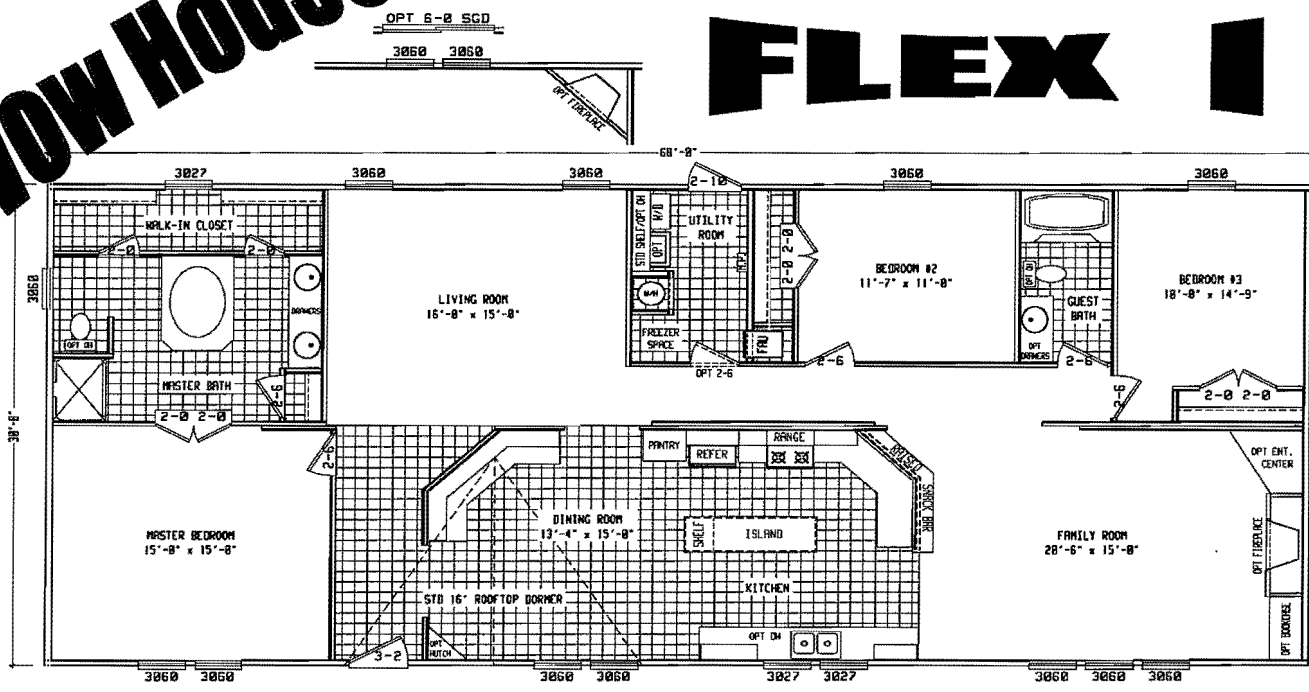

**MODEL: FLX3268G**  
 3 Bedroom, 2 Bath  
 2085 Sq.ft.



### Standard Features

- 1/2" Drywall**
  - \* Provides 40% more insulation value room to room
- Bigger Air Ducts**
  - \* 5 x14 vs. 4 x12 floor ducts 30% larger than competition
- Rolled Counter Top**
  - \* Commercial Grade, sturdier and easy to clean
- Ventilair III System**
  - \* Brings 7% fresh air to help rid stale and humid air
- Double Shelves**
  - \* Closets have double shelves for double storage space
- Water Shut Off**
  - \* In case of emergency, there is a master shut off.
- Door Stops**
  - \* Floor mounted door stops help protect your walls
- Large Water Lines**
  - \* 3/4" trunk line vs. 1/2" gives more consistent water pressure
- Heavy Ridge Beam**
  - \* Engineered lam beam (on double sections)
  - \* Full Length from hitch to end for structural support.
- 2-Part Adhesive**
  - \* Attaches sub floor to joist, prevents SQUEAKY floors, unlike the competition that uses wimpy white glue.
- Screws vs. Nails**
  - \* We use screws to assemble our walls, unlike the competition, because nails can pop out.

And much much more...



**325-641-9999**  
**325-793-9999**

